

Location of machine plate – Roboshot

ROBOSHOT α -SiA
ROBOSHOT S-2000iB
ROBOSHOT S-2000iA
ROBOSHOT α -iA

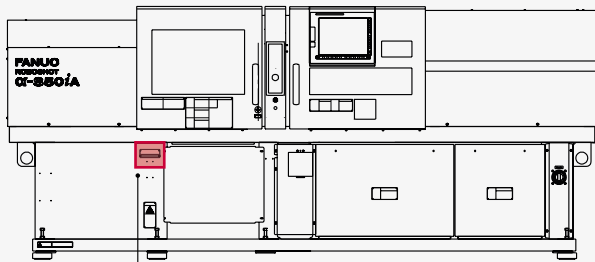

Machine serial No.

ROBOSHOT α -C

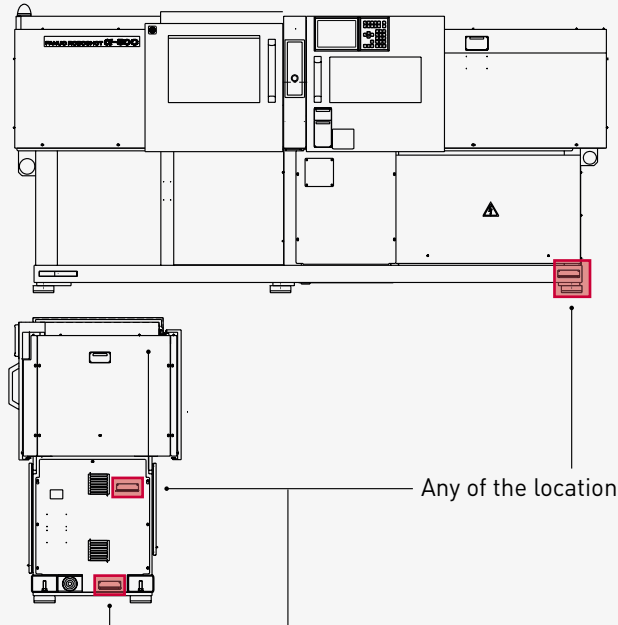

Any of the location

ROBOSHOT α -B
ROBOSHOT α -A
AUTOSHOT α -A

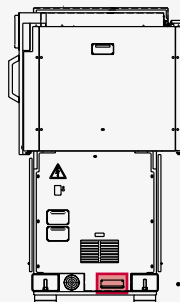
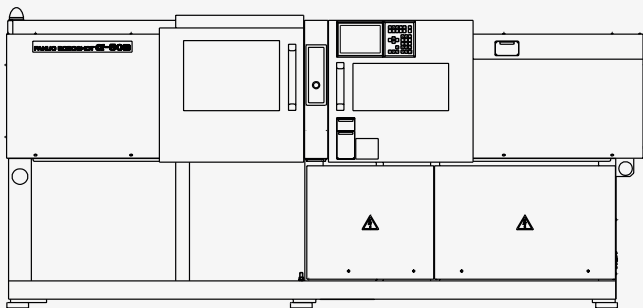

Machine serial No.



Location of machine plate – Roboshot

“MACHINE SERIAL NO, CNC SERIAL NO.” is confirmed on the operation screen or machine plate. However, for some of the old model, “MACHINE SERIAL NO, CNC SERIAL NO.” on the operation screen is not supported to display.

| Machine type | Machine Plate | Operation Screen | |
|------------------------|---------------|------------------|---------------|
| | | MACHINE S/N | CNC S/N |
| ROBOSHOT α -SiA | • | • | Δ (※1) |
| ROBOSHOT S-2000iB | • | • | Not Supported |
| ROBOSHOT S-2000iA | • | Not Supported | Not Supported |
| ROBOSHOT α -iA | • | | |
| ROBOSHOT α -C | • | | |
| ROBOSHOT α -B | • | | |
| ROBOSHOT α -A | • | | |
| AUTOSHOT α -A | • | | |

Table

(※1) α -SiA CE-SHOT edition 10.0 or newer

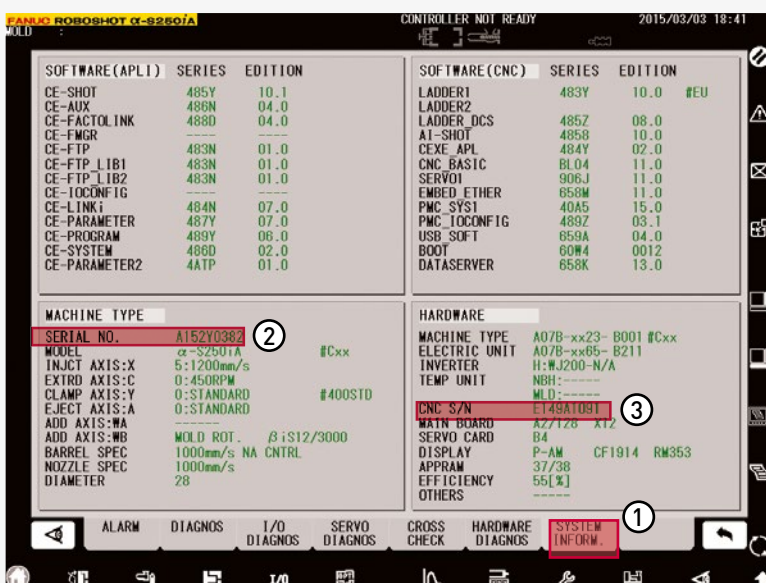

- ① System Information
 - ② Machine serial No.
 - ③ CNC serial No.
- ※ α SiA CESHOT edition 10.0 or newer

Sample